

2010 Green Home Tour Entry Form

TOUR DATES—May 15, 16, 22 and 23, 2010



This form MUST be complete! Each house must have an entry form.

Each house must also be entered in the GHBT certification program or the NAHBGreen certification program, and the builder must submit a calculator showing the ability to reach at least the Bronze level of certification. Upon completion of the house, the builder must submit a documentation package to GHBT containing sufficient materials to substantiate every item claimed in the calculator (or the copy of a certificate from NAHBGreen). Failure by the builder to complete the certification process would make the builder ineligible to enter any other green marketing events presented by GHBT during the following 12 months.

Please note: During tour hours, the tour entry must be staffed with a knowledgeable person who can explain the green features of the house.

Entry deadlines:

December 18, 2009 (Early Bird entry)

January 8, 2010 (Regular entry)

January 22, 2010 ((Final entry)

Please Type or Print. Fill in ALL Blanks.

Name of Builder Member Company: _____
EXACTLY AS YOU WANT IT TO APPEAR IN ALL OF THE PUBLICATIONS RELATING TO THE TOUR. EXACTLY.

Location of Home: Lot _____ Subdivision _____

Street Address: _____

City/Town: _____ County: _____

(entry will be listed in the city/county having inspection jurisdiction)

Price of Home: \$ _____ Certification program/projected level: _____

Heated Square Footage: _____ Sales Center/On-Site Phone Number: _____

(NOTE: This is the phone number that will be printed on tour materials.)

Home Plan by: _____

Builder or neighborhood website: _____

I am potentially interested in having GHBT members as volunteer greeters at my entry: _____ Yes _____ No

NOTE: THE FOLLOWING INFORMATION IS CRITICAL. THIS IS THE PERSON TO WHOM ALL CORRESPONDENCE RELATIVE TO THIS ENTRY WILL BE ADDRESSED — INCLUDING ANY LAST SECOND, EMERGENCY ANNOUNCEMENTS!

Contact Person: _____ Contact cell phone: _____

Office phone: _____ E-mail _____



Green Home Builders of the Triangle, c/o HBADOC
Phone (919) 493-8899 · fax (919) 490-7963



Green Tour Entry form, page 2

Concurrent event: Green Home Tour for NAHB's National Green Building Conference – Sunday, May 16, 2010

A small number of projects will be selected for a separate home tour that will be held in conjunction with NAHB's National Green Building Conference. While the tours will be happening at the same time, they are two distinct events. There may be some overlap in the sense that some homes may be in both tours; however, entry in GHBT's Green Home Tour is not necessary for a project to be considered for the conference tour. Please note that all local marketing efforts will be directed toward entries on GHBT's Green Home Tour; homes on the conference tour will be publicized primarily to conference attendees, and public marketing benefits from the conference tour are not likely.

The National Green Building Conference will be held at the Raleigh Convention Center on May 16, 17 and 18, 2010, and the conference tour will be a one-day event for conference attendees on Sunday, May 16. While the concept is similar to our Green Home Tour, there are several differences, as follows: 1) Attendees of the convention tour will be builders, remodelers, and other industry professionals who will be interested in the technical details and building science, as well as the marketing aspects of the entries; 2) Attendees of the convention tour will be paying for the tour; and 3) NAHB staff members will be handling the logistical details of the conference tour, although GHBT members will be assisting as local hosts.

If you wish to have your project considered for the conference tour, you will need to be prepared with sufficient staffing to host a busload of attendees at your home. You will be encouraged to invite GHBT volunteers to assist as hosts and tour guides in your home while the conference tour attendees are present. Several busloads may visit your home during the tour hours (from about 8 am to 2 pm), although there should only be one bus present at a time. At the request of the conference organizers, homes on the conference tour (if also on GHBT's Green Home Tour) will not be open to the public while the conference tour is being conducted, so you will not need to accommodate both audiences simultaneously.

In order to be considered for the conference tour, projects must be scored according to the ANSI National Green Building Standard and must be enrolled for GHBT or NAHB Green certification (or previously certified). Homes to be included in the conference tour will be selected by a panel consisting of GHBT members and the tour sponsor. The panel will aim for diversification of entries and will select entries that are within a reasonable distance of the convention center and the other homes on the tour. Homes can be under construction or finished and occupied. Selection criteria will include (but will not be limited to) the following: unique green features in the home; certification level achieved; interesting architecture or design features of the home; location of the home relative to the convention center and other selected homes; bus accessibility, and degree of completion of the project. Conference tour attendees will be particularly interested in viewing unique green features and technologies.

If your project is selected for the conference tour, you will be interviewed about your home by the editor for the convention tour book, and you will need to provide high-resolution photos that are suitable for print. You will also be required to release your project scoresheet, which may subsequently be printed in tour materials or posted on a website.

Please indicate below if you are interested in being considered for the conference tour. There will not be a separate entry form or fee for the conference tour, though entrants will need to provide the additional information requested by the selection panel. Please note that this is not a competition, and the greenest home doesn't necessarily get a spot on the conference tour. The panel will choose an exceptional and diverse group of homes that will help draw people to the conference and will educate all those who participate in this tour.

- I am entering only GHBT's Green Home Tour — Please note: Skip the rest of this page and fill out all remaining pages of this form.
- I am entering the GHBT 's Green Home Tour and would also like to have my project considered for the conference tour. Please note: You must fill out all remaining pages of this form and must also submit the other materials listed below.
- I would like to have my project considered for the conference tour but will not be entering GHBT's Green Home Tour. Please note: You must submit only pages 1 and 2 of this application no later than January 22, along with the additional materials listed below. No fees are required.

If you have checked either the second or third boxes above, please provide a narrative description of your project on an attached page. Be sure to address the selection criteria listed above. By January 22, you must also provide your ANSI scoresheet and copies of floorplans, the site plan, four elevations, and photos if available — all submitted electronically if possible.

Return this form with the appropriate pages to the HBADOC by mail (20 W. Colony PI, Suite 180, Durham, NC 27705) or by fax: 919-490-7963. You may also scan the entry form and submit it by email to: leigh@hbadoc.com. QUESTIONS? Contact Leigh Scott at 493-8899 or leigh@hbadoc.com.

Green Tour Entry form, page 3

Due by December 18, 2009 (Early Bird), January 8, 2010 (Regular entry) or January 22, 2010 ((Final entry) —

- Completed tour entry form, including authorization to use copyrighted materials;
- Completed certification application and calculator;
- Fees: tour entry fee and certification fee.

Due by February 15, 2010—

- Floor plans, bullet points, and directions to the house, submitted electronically if possible;

Due by March 15, 2010 —

- Professionally-drawn elevation or a high-resolution photo.

Please review the enclosed sample page (page 5) from a recent tour book before submitting the following materials:

HOUSE DESCRIPTION. Please give no more than **12 bullet points** that describe the green features of your entry. If possible, indicate the reason for a particular feature (i.e., for better indoor environmental quality). **Please submit your bullets via email to leigh@hbadoc.com.**

DIRECTIONS: THIS IS IMPORTANT!!! Provide directions from a major thoroughfare to your home. **If your home is located in a neighborhood, please include specific directions to the home from the entrance to the neighborhood.** Please do NOT include phrases like “follow the directional signs.” **Please submit your directions via email to leigh@hbadoc.com.**

FLOORPLANS: The floorplans submitted by the builder will be simplified for inclusion in the tour book. Please indicate any changes (such as a flipped plan or deletion of a room) when the floorplans are submitted. **Please submit the plans electronically if possible to leigh@hbadoc.com.**

FEES:

- Early Bird Entry Fee (must be received by Dec. 18, 2009) - \$800 _____
- Regular Entry Fee (received between Dec. 19, 2009, and Jan. 8, 2010) - \$850 _____
- Final Entry Fee (received between Jan. 9 and Jan. 22, 2010) - \$900 _____
- Discounted fee for 2nd or 3rd entry from the same builder (\$50 less, fill in the amount) _____

Important! The GHBT certification fee must also be paid when the entry is submitted unless the builder is using NAHBGreen for certification. See the GHBT certification application for information about GHBT certification fees.

Please note: You may be eligible to receive a **\$50 refund** if you attend one of the builder orientation breakfasts **AND** submit **all required materials** by the submission deadlines above. If you qualify, your refund will be sent following the tour. Or you can receive a **\$50 discount** if this is the 2nd or 3rd entry from the same builder. Total discount/refund for each entry is \$50.

_____ A representative from our company attended one of the orientation breakfasts, and we hereby apply for the refund, providing materials are submitted as required. (The entrant’s eligibility for the refund will be determined by HBA staff members.)

_____ Entry fee enclosed; please make check payable to HBADOC. _____ Please charge my credit card.

Type (only Visa/MC): _____ Number: _____

Name on card: _____ Expiration date: _____

Signature: _____ 3-digit security code on back of card: _____

Return this form including all pages (except page 5, the sample page from the book) to the HBADOC by mail (20 W. Colony PI, Suite 180, Durham, NC 27705) or by fax: 919-490-7963. You may also scan the entry form and submit it by email to: leigh@hbadoc.com. QUESTIONS? Contact Leigh Scott at 493-8899 or leigh@hbadoc.com.

Green Tour Entry form, page 4



SECTION I. This is my commitment and entry fee for a home in the 2010 Green Home Tour presented by the Green Home Builders of the Triangle (a joint Council of the Home Builders Association of Durham, Orange, and Chatham Counties and the Home Builders Association of Raleigh-Wake County). I will furnish all required materials (except photo or elevation) by February 15, 2010. The house photo or professionally-drawn elevation will be submitted by March 15, 2010. During the tour hours, I will ensure that the entry is staffed by a knowledgeable person who can explain the green features of the home.

SECTION II.

Mailing Address of Builder: _____

City, State, Zip: _____

ENTRY AFFIRMATION

The Builder and the HBAs (HBADOC and HBARWC) agree to indemnify and hold each other harmless from and against all claims, losses, costs, damages, expenses and liabilities for bodily injury, death, or property damage arising out of or in connection with any and all occurrences on or about the home, caused in whole or in part by the other.

BUILDER AGREEMENT

This entry is the result of an original design and I have obtained the legal right to use the design from the copyright owner and to the design as represented in the structure, plans, specifications and drawings for the house. I further represent that I have not pledged, assigned, or encumbered the rights to the design and that such design does not violate any copyright, property, or common law rights of others. I hereby indemnify and hold harmless HBADOC and HBARWC from any and all claims of third parties, including, but not limited to, copyright infringement or conversion, which may be asserted as a result of the inclusion of the house in the Tour or the inclusion of the drawings or floor plans of the house in any publication, including on the World Wide Web page, of the HBA publicizing or in conjunction with the 2010 Green Home Tour.

If an Act of God prevents the scheduled events from being observed, I agree that the Green Home Tour committee shall have the authority to re-schedule the Tour dates at its sole discretion.

Date: _____

Builder Company Name: _____

By: _____

Signature of Builder Member or Legally Authorized Representative



NEW DAY BUILDERS

27 Stoney Branch Trail, Price Creek, Chapel Hill
 \$697,000 ■ 3538 s/f ■ Sales: 919-969-9373
 www.newdaybuilders.com

Chatham County ■ Map# C1

Green Features

- Full, unfinished walkout basement using concrete Superior Walls
- ENERGY STAR® certified
- Home sited to optimize solar resource, with tree shade in summer and sunlight in winter
- Structured wiring and home automation system
- ENERGY STAR® rated windows by Andersen
- Tightly sealed door and continuous air barrier between garage and living area
- Air sealing package to reduce air infiltration on hot summer or cold winter days
- Gas furnace heating efficiency exceeds 90%
- All HVAC items, including fresh-air intake, sealed with mastic to reduce leakage
- Kitchen cooktop is vented to the outside
- Wood products in this home certified by the Sustainable Forestry Initiative and the Canadian Standards Association
- Wildlife habitat maintained on lot

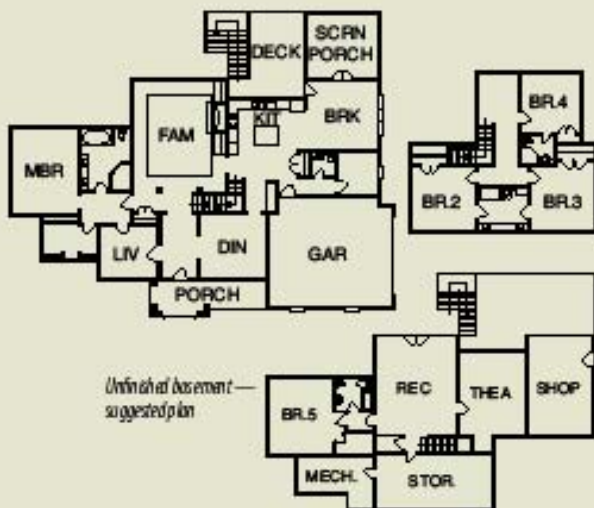

DIRECTIONS From Chapel Hill/Durham: Take 15/501 south 1.3 miles past Southern Village. Turn right onto Smith Level Road, and then take an immediate left onto Booth Rd. Turn left onto Amber Wood Run and left at the stop sign onto Stoney Branch Trail. It's the first house on the right.



OUT OF THE WOODS BUILDERS, INC.

174 Craig Hill Lane, Ridge Springs, Chapel Hill
 \$769,348 ■ 3629 s/f ■ Sales: 919-913-2541
 www.outofthewoodsbuilders.com

Chatham County ■ Map# C2

Green Features

- Sealed crawlspace, insulated with R-10 thermal max; aditional fan provided to ensure a constant air change
- Framing to include engineered wood products harvested from managed forest
- Low-VOC paints and stains
- Solar ready
- Photovoltaic ready
- Central vacuum installed to ensure indoor air quality
- Drought-resistant plants and grass
- ENERGY STAR® appliances used for reduced energy consumption
- Dual-fuel hybrid heat system used to offer the lowest energy consumption; all equipment properly sized
- House properly pressure balanced to help with heat loss and moisture control
- All areas affected by moisture will be properly vented to the outside
- All bedrooms to have both air supplies and returns in order to keep the house properly balanced

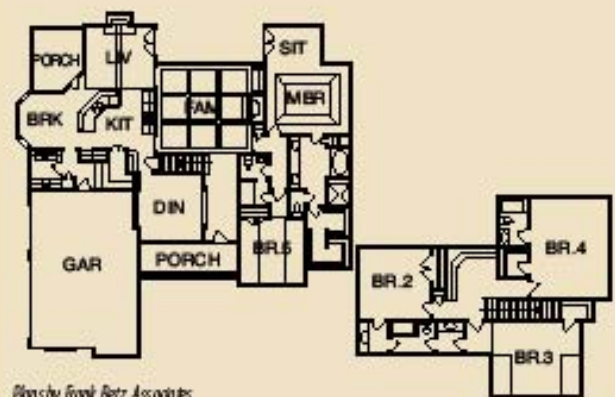

Plans by Frank Betz Associates

DIRECTIONS From 54 Bypass around Chapel Hill: Take Smith Level south to Booth Road, this is just before Smith level runs into 15-501. Turn right on Booth, go 1 mile and turn left on Amber Wood Run, go about 1 mile and it becomes Ridge Springs Drive. Go to the end, less than 1 mile and it has a cul-de-sac. Off of that cul-de-sac is an extension which goes downhill approximately 1200 feet. At the bottom is another cul-de-sac and the house is on the right.



Authorization to Use Copyrighted Materials

I hereby authorize the Green Home Builders of the Triangle (a joint Council of the Home Builders Association of Durham, Orange & Chatham Counties and the Home Builders Association of Raleigh-Wake County) to publish in its 2010 Green Home Tour publications the HBA's rendition of copyrighted elevations and floorplans.

This authorization applies to the home plan known as

_____ (official plan name and number; file number)

By signing this authorization, the undersigned represents that (s)he has the authority to authorize the publication of the copyrighted materials.

This is the ____ day of _____, 20__.

_____ Print or Type Name of Company

_____ Print or Type Name of Company

By: _____ Plan Designer/Copyright Owner

By: _____ Builder

Note to Plan Designer/copyright Owner:

After execution of the above, please forward this authorization form directly to the Green Home Builders of the Triangle at the HBA of Durham, Orange & Chatham Counties as soon as possible, but no later than March 15, 2010. If this form is not in the hands of the HBA on or before March 15, 2010, the elevation and floorplan **will not** be included in the publications, including the website.

Green Home Builders of the Triangle
Home Builders Association of Durham, Orange & Chatham Counties
20 W. Colony Place, Suite 180
Durham, North Carolina 27705

