



ALFERMANN CONSTRUCTION COMPANY, LLC

1731 Old Lystra Road, Chapel Hill

\$479,000 | 2,200 s/f | Sales: 919-730-1109

www.alfermann.com

MAP# 04 | ORANGE COUNTY



- GHBT certification in progress
- Sun-tempered design for passive solar heating and cooling
- Apricus® solar domestic water pre-heater tied in to radiant floor heating
- High-efficiency, clean-burning Morso wood stove for backup heat
- Sealed crawl space for improved indoor air quality and energy efficiency
- High-efficiency HVAC system with Aprilaire® filter; EQC designed and fully pressure balanced
- Natural, non-toxic wood finishes and Harmony® low-VOC paint
- House pre-plumbed for rainwater flush and greywater systems; dual-flush toilets
- Trees harvested and milled on-site and dried before use in solar kiln; waste turned into mulch
- Fully-engineered rainwater catchment system
- 2" x 6" and 2" x 8" walls packed with dense blown cellulose; Autoclaved Aerated Concrete block used below grade in living space
- Living roof fully designed by Green Sky Inc.; metal roof by Walker Brown Roofing
- Salvaged/reclaimed materials used throughout dwelling

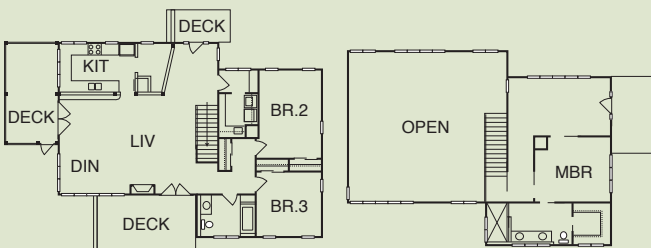

Plan by Dave Kurtz and Design Elements (Stacie Schreiner)

DIRECTIONS: FROM I-40, take Hwy 54 towards Chapel Hill. Get onto 15-501/54 Bypass towards Carrboro. Take the exit for 15-501 south to Pittsboro. Turn left onto Mount Carmel Church Road. Go 6/10 of a mile. Take a slight right turn onto Old Lystra Road. Go 1.6 miles. Driveway will be on the right directly before a hard left turn (4 big yellow arrows pointing left).

FROM PITTSBORO, take 15-501 North towards Chapel Hill. Turn right on Old Lystra at the first right after Cole Park Plaza. Go 1.9 miles. After passing the Sun Forrest subdivision on the left, there will be a hard right turn. Driveway is on the left.



BUILDSENSE

130 Cole Drive, Chapel Hill

Not for Sale | 2,130 s/f | Sales: 919-667-0404

www.buildsense.com

MAP# 05 | ORANGE COUNTY



- GHBT certification in progress
- Proper solar orientation with southern glazing for supplemental heat in the winter and shading devices to keep home cool in the summer
- 2.7 KW photovoltaic array installed by Southern Energy Management
- Radiant slab heat by Solar Consultants for supplemental heating and optimal comfort
- High-efficiency 15 SEER heat pump with fresh air intake and dedicated returns
- Water-conserving fixtures and a plumbing manifold water distribution system
- Low-E, Argon-filled Pella Proline doors and windows
- 2" x 6" in-line advanced framing and resource-efficient roof truss construction
- Icynene® spray foam insulation by FormWorx
- Durable, low-maintenance interior finishes with no-VOC paints
- Rainscreen siding system featuring no-maintenance, aluminum-panel siding by Alpine Roofing and low-maintenance cedar
- Landscape featuring native and drought-tolerant plantings
- ENERGY STAR® home designed to perform 32% better than code

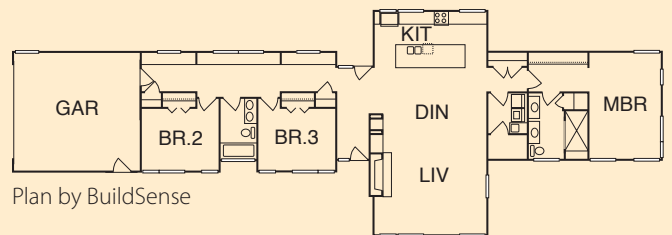

Plan by BuildSense

DIRECTIONS: FROM I-40 IN DURHAM/CHAPEL HILL, take exit 273A (Chapel Hill, Hwy 54) and merge onto Hwy 54. Drive 3 miles and exit onto 15-501/54 toward Carrboro. Take the exit for 15-501 South toward Pittsboro. Go left off exit ramp and drive 2.3 miles. Cole Drive is on the right.