

ERSKINE ROW \$549,900



COMMONWEALTH CONSTRUCTION & DESIGN, INC.

919-929-6182 ■ www.briarchapelnc.com ■ 3,171 s/f

133 Saxapahaw Run, Chapel Hill ■ Briar Chapel

OFFERED BY: COLDWELL BANKER ADVANTAGE NEW HOMES, INC., 919-969-1617

HOUSE PLAN BY: BSA HOME PLANS, ROBERT MARTIGNONI, AIBD



FEATURES

- Wine cellar
- Master retreat on main level
- 10' ceilings on 1st floor, 9' ceilings on 2nd
- Dual fuel combination gas/heat pump on 1st floor (economical split fuel source)
- Aprilaire® 5000 Merve 10 media filter/electronic whole house air cleaner
- 8" fresh air intake to ensure healthy living indoor air quality
- NORITZ® tankless water heater
- Instant hot and cold water dispenser
- Two flush water-saving elongated toilets
- Water-saving faucets and shower heads in every bath
- Green Home Builders of the Triangle certification in progress; ENERGY STAR® features offer up to 30% savings on heating and cooling — up to 50% savings on water heating utility bills

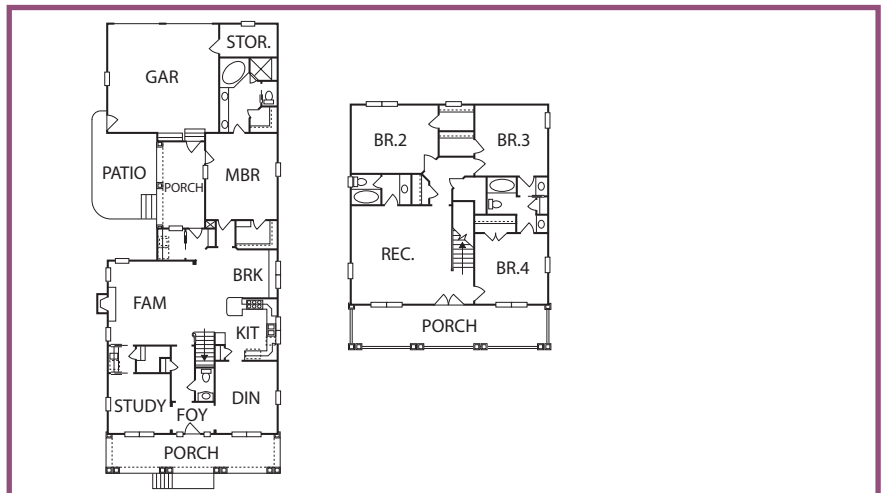

DIRECTIONS From Chapel Hill: Take Hwy. 15-501 South (toward Pittsboro) approximately 7 miles. Turn right on Briar Chapel Pkwy (Briar Chapel main entrance). Drive 1.5 miles (cross the bridge) and turn left on Saxapahaw Run, before traffic circle. Parade house is the 2nd house on right.

From Apex/Cary: Take Hwy. 64 West across Lake Jordan. Turn right on Mt. Gilead Church Rd. Turn right on hwy. 15-501 North. Turn left on Briar Chapel Pkwy. (Briar Chapel main entrance). Drive 1.5 miles (cross the bridge) and turn left on Saxapahaw Run, before traffic circle. Parade house is the 2nd house on right.