

LAWRENCE F \$265,712

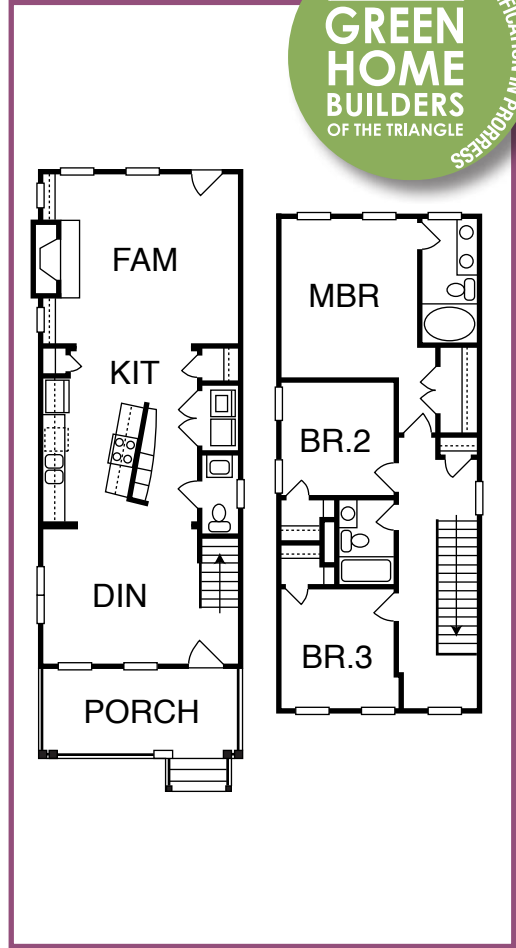

MCNEILL BURBANK HOMES

919-781-5225 ■ www.mcneillburbank.com ■ 1,584 s/f
72 Grovewood Lane, Chapel Hill ■ Briar Chapel

OFFERED BY: MCNEILL BURBANK HOMES, 919-240-5800 ■ HOUSE PLAN BY: MCNEILL BURBANK HOMES



FEATURES

- Green Home Builders of the Triangle certification in progress
- ENERGY STAR® certified
- Australian cypress hardwood flooring
- Granite countertops with subway tile backsplash
- Venetian bronze hardware
- Custom built-in storage
- 9' ceilings upstairs and down
- Native stone columns on front porch
- Two car garage
- Green space view

DIRECTIONS

From Chapel Hill, take 15-501 South toward Pittsboro. Briar Chapel is approximately 7 miles South on the right. Follow Briar Chapel Parkway to the traffic circle. Turn right on Great Ridge Parkway. Turn left on Grovewood Lane. This home is on the left.