



### DILLON BUILDERS, INC.

233 Churchwood Lane Extension, Pittsboro  
 \$230,000 | 1,800 s/f | Sales: 919-656-4113  
 www.dillonbuildersinc.com

**MAP# C1 | CHATHAM COUNTY**



- GHBT certification in progress
- ENERGY STAR® certified home
- Sealed crawl space for improved energy efficiency and indoor air quality
- THERMAX radiant barrier roof sheathing
- Low-E, energy-efficient windows
- Low-VOC paints
- Low-maintenance Hardie exterior siding and MiraTEC trim
- All plumbing and HVAC ductwork in conditioned space
- Advanced framing techniques to reduce waste and increase insulation coverage
- Water-conserving shower heads and toilets
- RSF wood burning fireplace
- Roughed-in central vacuum system
- Home site adjacent to Town Lake Park Trail

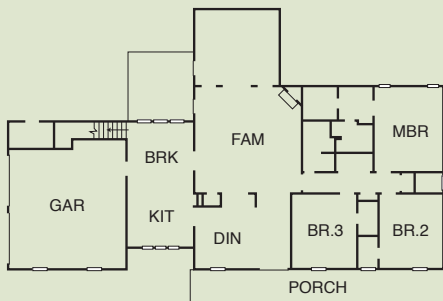

Plan by Home Plans Studio

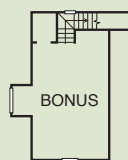

**DIRECTIONS:** Take 64 Business West from the traffic circle in downtown Pittsboro. Take a left on Hwy 87 South at Al's Diner. Take a left on Churchwood Lane. Take the gravel drive on the left at the bottom of the hill.



### CHATHAM HABITAT FOR HUMANITY

57 Thelma Sugg Lane, Pittsboro  
 \$130,000 | 1,103 s/f | Sales: 919-542-0794, ext 216  
 www.chathamhabitat.org

**MAP# C2 | CHATHAM COUNTY**



- GHBT certification in progress
- Passive solar design: warm and sunny in winter; cool and shady in summer
- Low utility bills and low maintenance requirements
- Autoclaved, aerated concrete (AAC) exterior wall system: fire-, bug-, and rot-resistant, sound absorbent, no maintenance; withstands 140 mph winds
- Interior finished with mineral plaster; exterior finished in no-maintenance real stucco
- In-floor radiant hydronic heating system; on-demand hot water and active solar panel water heating systems
- Blown-in attic insulation with recycled content
- 26-gauge metal, ENERGY STAR® rated roof
- Low-E, energy-efficient windows in the north, east, and west elevations
- Tinted, poured concrete floor
- Energy efficiency standards meet or exceed Advanced Energy's SystemVision program requirements, guaranteeing an average of \$33 per month for the heating and cooling portion of the electric bill
- Low-VOC paint
- Aging-in-place, Universal Design Features throughout

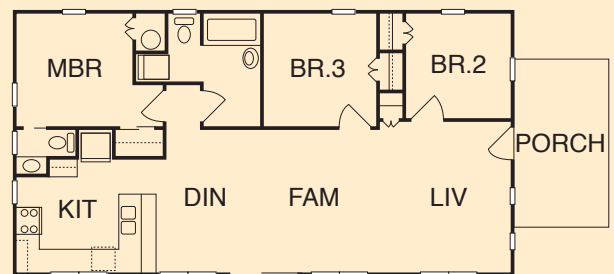

Plan by Sun Garden Houses

**DIRECTIONS:** From CHAPEL HILL/CARRBORO, take 15/501 South to Pittsboro. (If coming from Raleigh, take the Business 64 exit into Pittsboro to the traffic circle.) At the Pittsboro traffic circle, take the 'exit' onto Highway 64 West toward Siler City. At the next stoplight, take a left onto NC Hwy 87. Take the first right turn onto Brown Street, which is the first street after Al's Diner on NC 87. At the end of Brown Street, take the last right onto Thelma Sugg Lane (gravel road). The house is the second on the left.