

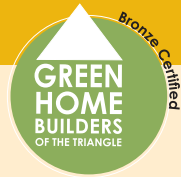

TOLL BROTHERS, INC.

Neighborhood: The Hills at Southpoint
 103 South Bend Drive, Durham
 \$1,500,000 | 7,100 s/f | Sales: 919-806-8655
 www.hillsatsouthpoint.com

MAP# D8 | DURHAM COUNTY



This home is a furnished model.

- GHBT Bronze level certification
- ENERGY STAR® certified home+
- Icynene® spray foam insulation
- High-efficiency, Low-E windows
- On-demand, tankless water heater
- High-efficiency HVAC system with environmentally-friendly Puron refrigerant
- Engineered truss system and panelized wall system
- Water-conserving toilets and low-flow faucets
- Environmentally-friendly storm water design
- Incorporation and restoration of existing slopes, trees and ponds
- Low-VOC paints and carpets
- ENERGY STAR® appliances
- Engineered hardwood flooring

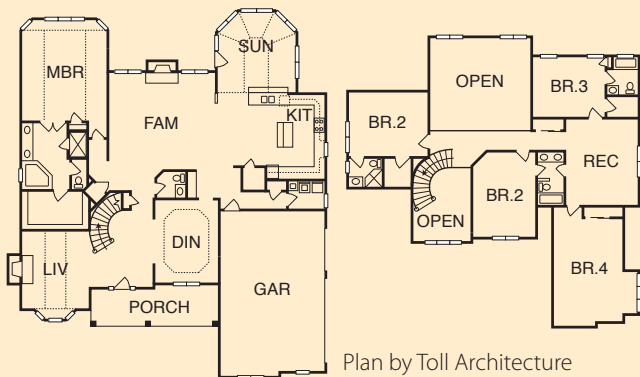

DIRECTIONS: FROM I-40, take exit 276 (Fayetteville Road). Drive toward the Streets at Southpoint shopping center and proceed approximately 1 mile. Turn left into the community entrance for The Hills at Southpoint.



SNYDER HANKINS CUSTOM HOMES, INC.

Neighborhood: Keeneland Manor
 215 Keeneland Court, Durham
 \$859,900 | 3,996 s/f | Sales: 919-870-6339
 www.snyderhankinscustomhomes.com

MAP# D9 | DURHAM COUNTY



- GHBT certification in progress
- ENERGY STAR® rated with HERS index rating of 74
- LP TechShield® radiant roof barrier to keep home cooler and save energy
- Maintenance-free exterior, including brick, stone, and PVC rot-free trim boards
- Multiple third-party inspections to ensure energy efficiency and green benefits
- Water-efficient fixtures: < 2.5 gallons per minute showerheads, 2.2 gallons per minute faucets, and low-flow toilets
- Wildlife habitat maintained on lot and in neighborhood open space
- 90% efficient HVAC system with programmable thermostats, air transfer grilles, fresh air ventilation, and variable speed air handler
- Eco-friendly Lyptus wood cabinets; Low-VOC paints
- House properly pressure balanced to control moisture and indoor air quality
- Multiple-zone, rain-sensor-controlled irrigation system for efficient water use, featuring drip irrigation in planting beds and gutters piped to benefit turf needs
- Shrubs and grass selected for this growing zone and grouped for similar watering needs
- ENERGY STAR® appliances, bathroom fans and insulated Low-E windows

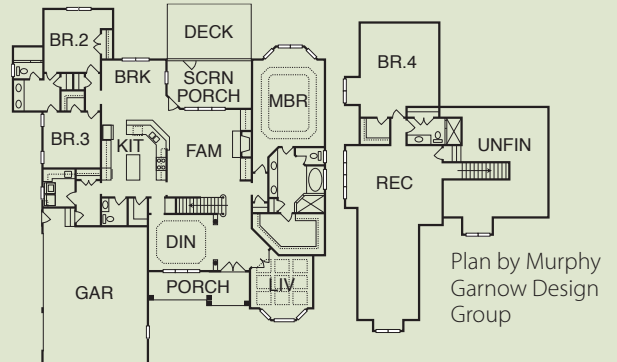

DIRECTIONS: FROM I-40 NEAR CHAPEL HILL/DURHAM, take exit 274. Proceed south on Highway 751. Turn right on Stagecoach Road, then turn left into Keeneland Manor on Keeneland Court. Home is located on the left.