



**OUT OF THE WOODS BUILDERS, INC.**

Neighborhood: Ridge Springs  
 174 Craig Hill Lane, Chapel Hill  
 \$723,000 | 3,629 s/f | Sales: 919-913-2541  
 www.outofthewoodsbuilders.com

**MAP# C7 | CHATHAM COUNTY**



- GHBT Silver level certification
- Sealed crawlspace, insulated with R-10 thermal max; additional fan provided to ensure a constant air change
- Framing includes engineered wood products harvested from managed forest
- Low-VOC paints and stains
- Solar ready
- Photovoltaic ready
- Central vacuum installed to ensure indoor air quality
- Drought-resistant plants and grass
- Energy Star® appliances used for reduced energy consumption
- Dual-fuel hybrid heat system used to offer the best energy consumption; all equipment properly sized
- House properly pressure balanced to help with heat loss and moisture control
- All area affected by moisture will be properly vented to the outside
- All bedrooms have both air supplies and returns in order to keep the house properly balanced

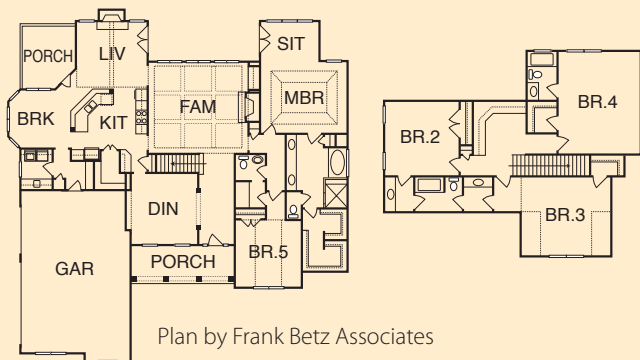

**DIRECTIONS:** Take Smith Level South to Booth Road; this is just before Smith Level runs into 15-501. Turn right on Booth, go 1 mile and turn left on Amber Wood Run, go about 1 mile and it runs into Ridge Springs Drive. Go to the end—less than 1 mile—and it has a cul-de-sac. Off of that cul-de-sac is an extension which goes downhill maybe 1200 feet. At the bottom is another cul-de-sac and the house is on the right.



**MCF BUILDERS OF CHATHAM COUNTY, LLC**

Neighborhood: Bingham Ridge  
 53 Bingham Ridge Drive, Pittsboro  
 Not for Sale | 3,205 s/f | Sales: 919-942-9214  
 www.mcfbuilders.com

**MAP# C8 | CHATHAM COUNTY**



- GHBT certification in progress
- Located in a neighborhood of active solar homes
- ENERGY STAR® certified home uses less energy and qualifies homeowner for 5% discount on Progress Energy bills
- Solargenix solar hot water system can provide 80%–100% of hot water needs
- Grid-tied, 2 kWh photovoltaic array and OutBack inverter, designed to offset energy costs
- Passive solar orientation for day lighting and winter heat gain
- High-performance, Argon-filled, Low-E windows by Hurd; Therma-Tru insulated doors
- Icynene® spray foam insulation throughout; sealed crawl space and attic for healthier indoor air and optimal HVAC performance
- Engineered HVAC system with dual fuel heat pump, variable speed fan, air returns and engineered air load delivery in every room, fresh air intake and programmable thermostats
- All fluorescent and compact fluorescent lighting; ENERGY STAR® appliances and central vacuum
- Low-maintenance, rot-resistant exterior with HardiePlank® siding, MiraTEC trim, and ChoiceDek® decking
- Dual-flush and low-volume toilets; low-flow shower heads and faucets
- Formaldehyde-free cabinetry with low-VOC finish; Sherwin-Williams low-VOC paints

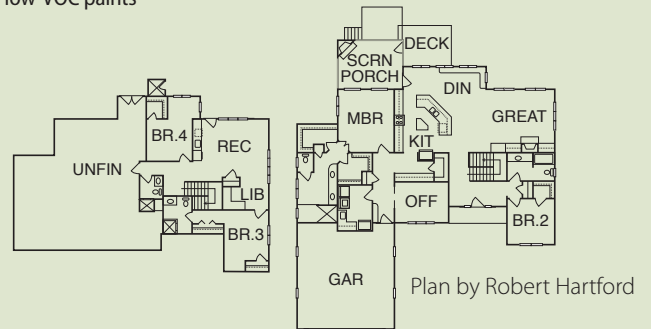

**DIRECTIONS:** FROM CHAPEL HILL, take 15-501 South approximately 4 miles. Turn right onto Mann's Chapel Rd. Go 2 miles and turn right onto Poythress Rd. Bear left at the white chapel onto Lamont Norwood Rd. Go 2 miles, then turn right onto Bingham Ridge Dr. House is the second driveway on the left. House sits back from the street.